

东莞市志展五金塑胶制品有限公司

DongGuan ZhiZhan Hardware Plastic Products Co., LTD

TEL:0769-81802125

FAX:0769-81802126

DOCUMENT NO.

RDE0605A

SERIAL NO.

A2501H00-NP

*Material: Nylon 66 UL 94V-0(white)

Specifications:

Poles	2-16Poles
Pitch between poles	2.50mm
Rated Voltage	250V AC,DC
Rated Current	3A(AWG#22)
Withstand Voltage	1000V AC/minute
Contact Resistance	20mΩ(MAX)
Insulation Resistance	1000mΩ(MIN)
Temperature Range	-25°C ~ +95°C*
Applicable Wire Range	AWG #18 ~ #32

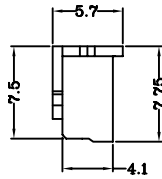
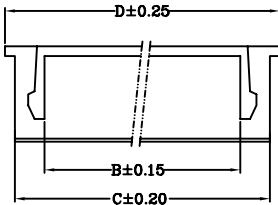
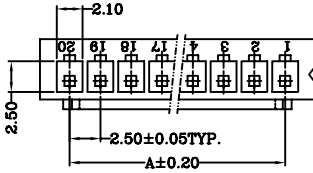

Dimensional & Ordering Information:

Circuits	Part No	Dimensions				PCS/BAG
		A	B	C	D	
2	A2501H00-2P	2.50	0.90	5.70	7.30	1000
3	A2501H00-3P	5.00	3.40	8.20	9.80	1000
4	A2501H00-4P	7.50	5.90	10.70	12.30	1000
5	A2501H00-5P	10.00	8.40	13.20	14.80	1000
6	A2501H00-6P	12.50	10.90	15.70	17.30	1000
7	A2501H00-7P	15.00	13.40	18.20	19.80	500
8	A2501H00-8P	17.50	15.90	20.70	22.30	500
9	A2501H00-9P	20.00	18.40	23.20	24.80	500
10	A2501H00-10P	22.50	20.90	25.70	27.30	500
11	A2501H00-11P	25.00	23.40	28.20	29.80	500
12	A2501H00-12P	27.50	25.90	30.70	32.30	500
13	A2501H00-13P	30.00	28.40	33.20	34.80	500
14	A2501H00-14P	32.50	30.90	35.70	37.30	500
15	A2501H00-15P	35.00	33.40	38.20	39.80	500
16	A2501H00-16P	37.50	35.90	40.70	42.30	500
20	A2501H00-20P	47.50	45.90	50.70	52.30	500

A2501 Series 2.50mm pitch crimp terminal

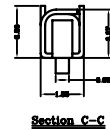
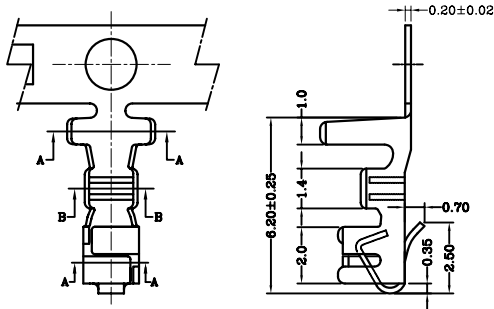

Specification & Ordering Information:

Part No	Wire Range	Insulation O.D.	Material	Finish	Qty/reel
A2501T0B-2	AWG #22~#28	1.90mm(max)	Brass	Tin-plated	7,000 PCS
A2501T0P-2	AWG #22~#28	1.90mm(max)	Phosphor bronze	Tin-plated	7,000 PCS

东莞市志展五金塑胶制品有限公司

DongGuan ZhiZhan Hardware Plastic Products Co., LTD

TEL:0769-81802125

FAX:0769-81802126

DOCUMENT NO.

RDE0605A

SERIAL NO.

A2501WVR

A2501 Series 2.50mm pitch wafer (V-Type)

Material: *Insulator: Nylon 66 UL 94V-0

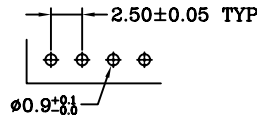
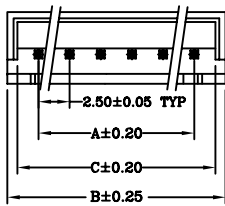

P.C.B LAYOUT

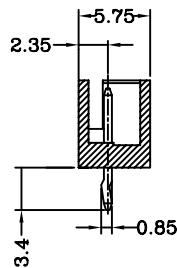
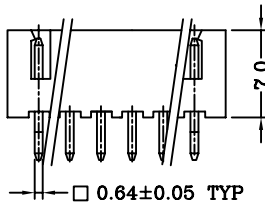

Dimensional & Ordering Information:

Circuits	Part No	Dimensions			PCS/BAG
		A	B	C	
2	A2501WV0-2P	2.50	7.50	6.10	1000
3	A2501WV0-3P	5.00	10.00	8.60	1000
4	A2501WV0-4P	7.50	12.50	11.10	1000
5	A2501WV0-5P	10.00	15.00	13.60	1000
6	A2501WV0-6P	12.50	17.50	16.10	1000
7	A2501WV0-7P	15.00	20.00	18.60	500
8	A2501WV0-8P	17.50	22.50	21.10	500
9	A2501WV0-9P	20.00	25.00	23.60	500
10	A2501WV0-10P	22.50	27.50	26.10	500
11	A2501WV0-11P	25.00	30.00	28.60	500
12	A2501WV0-12P	27.50	32.50	31.10	500
13	A2501WV0-13P	30.00	35.00	33.60	500
14	A2501WV0-14P	32.50	37.50	36.10	500
15	A2501WV0-15P	35.00	40.00	38.60	500
16	A2501WV0-16P	37.50	42.50	41.10	250
17	A2501WV0-17P	40.00	45.00	43.60	250
18	A2501WV0-18P	42.50	47.50	46.10	250
19	A2501WV0-19P	45.00	50.00	48.60	250
20	A2501WV0-20P	47.50	52.50	51.10	250

A2501 Series 2.50mm pitch wafer (R-Type)

Material: *Insulator: Nylon 66 UL 94V-0

*Contact: Brass, Tin Plated

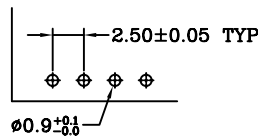
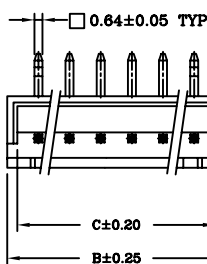

P.C.B LAYOUT

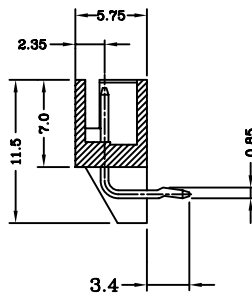
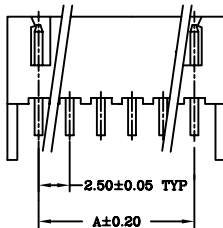

Dimensional & Ordering Information:

Circuits	Part No	Dimensions			PCS/BAG
		A	B	C	
2	A2501WR0-2P	2.50	7.50	6.10	1000
3	A2501WR0-3P	5.00	10.00	8.60	1000
4	A2501WR0-4P	7.50	12.50	11.10	1000
5	A2501WR0-5P	10.00	15.00	13.60	1000
6	A2501WR0-6P	12.50	17.50	16.10	1000
7	A2501WR0-7P	15.00	20.00	18.60	500
8	A2501WR0-8P	17.50	22.50	21.10	500
9	A2501WR0-9P	20.00	25.00	23.60	500
10	A2501WR0-10P	22.50	27.50	26.10	500
11	A2501WR0-11P	25.00	30.00	28.60	500
12	A2501WR0-12P	27.50	32.50	31.10	500
13	A2501WR0-13P	30.00	35.00	33.60	500
14	A2501WR0-14P	32.50	37.50	36.10	500
15	A2501WR0-15P	35.00	40.00	38.60	500
16	A2501WR0-16P	37.50	42.50	41.10	250
17	A2501WR0-17P	40.00	45.00	43.60	250
18	A2501WR0-18P	42.50	47.50	46.10	250
19	A2501WR0-19P	45.00	50.00	48.60	250
20	A2501WR0-20P	47.50	52.50	51.10	250